

PIPE-500NPS-18

600 lb WLL

1/2" SCHED 40 NPT THREADED PIPE

STEEL PIPE



Threaded and Painted

PAINTED PIPE SECTIONS

Adaptive provides kits of pre-painted, fixed length sections with threaded pipe and safety cables for use in vertical suspensions of equipment and other objects. Secure any of these pipe sections above to one of Adaptive's heavy-duty ceiling mounts or strut channel adapters and a variety of adapters and mounts below.

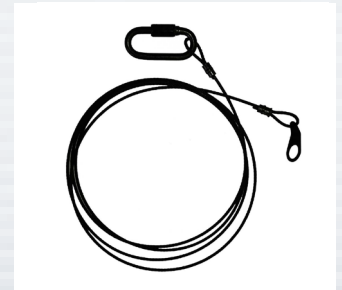

Safety Cable Included



KEY FEATURES:

- ▶ Pipe Sections are pre-threaded
- ▶ Body is powder coated black
- ▶ Pre measured safety cable included

OPTIONAL ACCESSORIES:

- ▶ See Ceiling Mount datasheet
- ▶ See Strut Attachment datasheet
- ▶ 1.5" to .5" Pipe Reducer (PIPE-1.5-500-PR)
- ▶ 1.5" Threaded Pipe Coupler (CG-150NPS-PC)
- ▶ .5" Threaded Pipe Coupler (PIPE-500-CPLNG)

SPECIFICATIONS:

Material: Schedule 40 Steel Pipe
Finish: Powder Coat
Color: Black
Design Factor: 5:1
Safety Cable: 120lbs
WLL: 600 lbs / 272 Kg.
Shipping Weight: See Table

PACKAGE CONTENTS:

1 pc Pipe, 1/2" dia. x 18" Long
1 pcs Safety Cable, 50" Long
1 pcs Flat Washer, 1/4"
1 pcs Quick Link, 1/4"



Rated for indoor use.

DIMENSIONS

OPTIONAL THREADED PIPE COUPLERS

PIPE-1.5-500-PR

PIPE-500-CPLNG

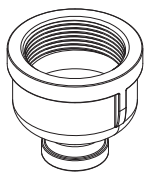

1-1/2" to 1/2"
Pipe Reducer

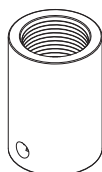

1/2" NPS
Pipe Coupler

Side View

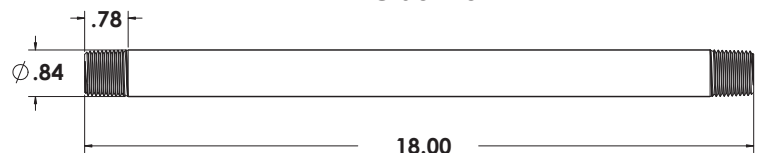

1/2" Part #	A (Length)	Shipping Weight
PIPE-500NPS-18	18" Long Pipe	1.5 lb / .68 Kg

Adaptive Technologies Group
 1635 E. Burnett Street | Signal Hill, CA 90755 USA
 Ph: 562.424.1100 | Fax: 562.424.3520
 www.adaptivetechgroup.com



ALWAYS INSTALL SAFETY CABLES

WARNING: Mounting and/or suspension of equipment requires experienced professionals. Improperly installed equipment can result in property damage, personal injury and/or liability to the installing contractor.