

DIY Video Wall Framing

Build any size LED video wall frame using Adaptive's universal-fit off-the-shelf LED mounting components, onto common strut channel. Shorter lead times and at a fraction of the cost of custom fabricated video wall frames.

Easy to rearrange configurations, add, subtract or change tiles, and for any LED tile size.

StrutWall's attachments include adjustable side and center mounts, offering precise X, Y & Z adjustments, end to end joiner brackets for larger video walls, horizontal strut spacers, frame levelers and first tier landing plates. These components allow any size video wall frame to be assembled, limited only by the size of the facility's mounting surface.

Adaptive's StrutWall components are offered in both indoor and outdoor applications, and fit 13/16" and 1-5/8" strut channel brands, such as UniStrut, Superstrut, Adamax, B-Line, U-Strut and others. For best results, select front access tiles.

STANDARD FEATURES:

- ▶ DIY Video Wall Framing
- ▶ Surface mount any size video wall
- ▶ Add, subtract or change tiles quickly
- ▶ Easy to install and adjust
- ▶ Short lead times over custom walls
- ▶ Lower cost than custom frames

OPTIONAL ACCESSORIES:

- ▶ Wall Leveler
- ▶ End to End Joiner Bracket
- ▶ Perimeter Tile Bracket
- ▶ Center Mount Bracket
- ▶ Landing Bracket
- ▶ Corner Gusset

SPECIFICATIONS:

Materials: Steel
Finish: Zinc Plate
Color: Silver

Patent Pending



**Center Mount
SW-CM-LED-MNT**



**Perimeter Mount
SW-LR-LED-MNT**

Step 1: Build Strut Frame

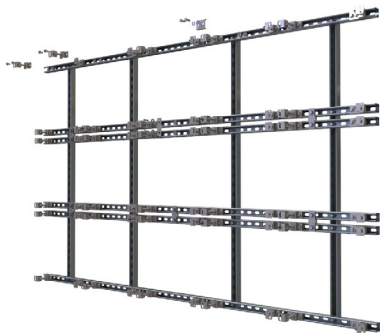

Install vertical struts to a flat wall or wood backing first, one strut per every two columns. Use wall levelers if necessary. Install horizontal strut over the vertical strut using spacers.

Step 2: Install Tiles Using StrutWall™

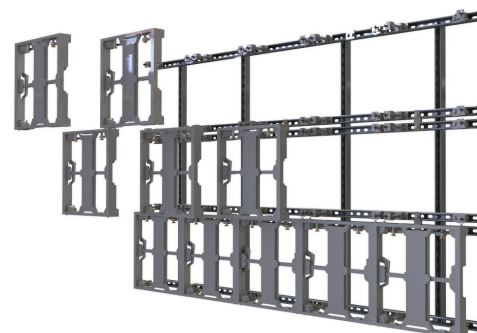

Cut vertical and horizontal strut sections to the lengths needed that will accommodate the selected LED tile, and the size of the desired video wall configuration, such as the above 5X3.

If selected, install Landing Brackets first install along the bottom strut. Install adjustable Side and Center mounts where the LED tiles will be. Attach LED frames to the Side and Center Mounts. Once aligned and plumbed, the pixel boards may be attached.

StrutWall™

UNIVERSAL LED VIDEO WALL FRAMING

STRUTWARE™

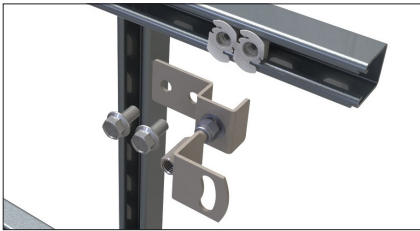

SIDE MOUNT

SW-LR-LED-MNT

The X, Y & Z adjustable Side Mounts secure a video wall's outer left and right LED columns by securing to their two lower and upper outer corner mounting holes. Center Mounts are used on their inner left and right mounting holes. Hardware is included.

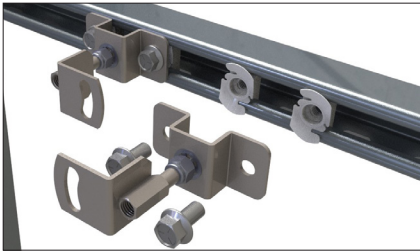

CENTER MOUNT

SW-CM-LED-MNT

The X, Y & Z adjustable Center Mounts secures all four LED mounting holes between the left and right columns. They also secure the two inner mounting holes of the left and right columns. Hardware is included.

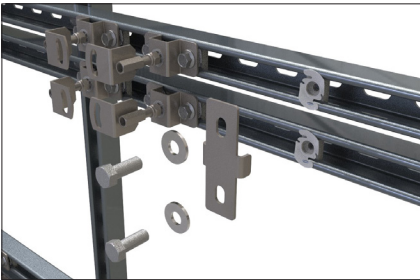

HORIZONTAL SPACER

SW-HS-LED-XXXX

This model specific spacer, based on the selected LED model, assures the distance between two horizontal struts and that they are in parallel. See LED cross reference for part number.

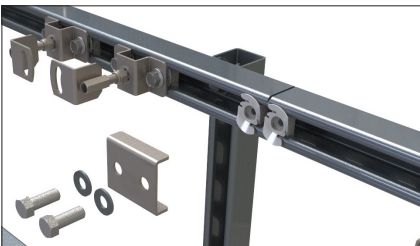

END TO END JOINER

SW-E2E-LED-BRKT

This joiner bracket is usually used on larger video wall frames over 10 feet long, where two or more strut channels are joined together vertically or horizontally. Bolts and channel nuts are included in the kit.



WALL LEVELER

SW-WL-LED-W

Use this fitting to "float" strut frames over uneven wood surfaces, such as plywood. The leveler provides up to 3/4" +/- adjustments between the wall backing and strut frame. Use concrete anchors on block or cement walls.

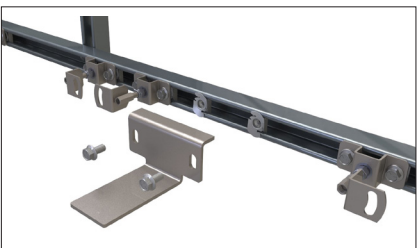

LANDING BRACKET

SW-LB-LED-BRKT

To help line up the first (bottom) tier, install a Landing Plate to the lower strut channel, in the center of where each LED tile will be secured. Hardware is included.

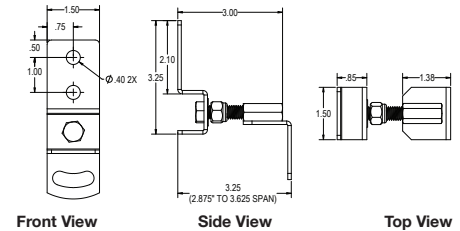

Front View

Side View

Top View

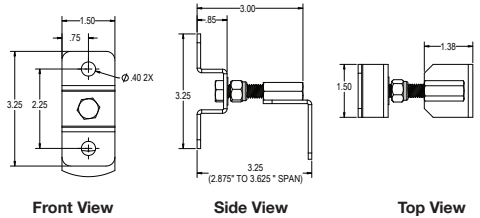

Front View

Side View

Top View

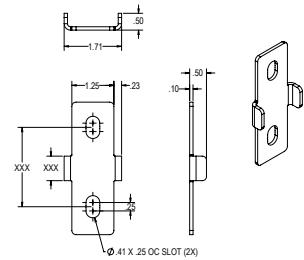

HORIZONTAL SPACER BRACKET

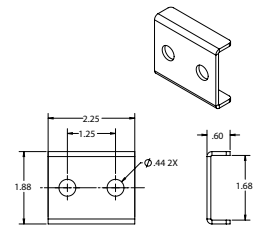

END TO END JOINER BRACKET

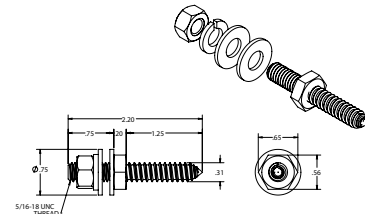

5/16-18 UNF. THROUGH

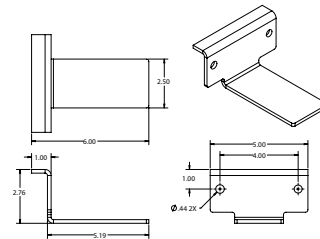

LANDING BRACKET