

(400 lb. WLL)

# ELECTRO-VOICE CLUSTER PACK PLANAR ARRAY KIT

**FASPAC™**

The FP-EVH1152-2X1 planar array kit gives designers, contractors and audio consultants the ability to create two EVH 1152 speakers in a tight pack or splayed configurations. The FP-EVH1152-2x1 kit provides a method of flying a planar or line array configuration while offering the capability of allowing cabinet's splay angle to be adjusted relative to each other to find the optimum sound directivity. A series of holes are provided to easily adjust the splay or tilt angle from 20° to 60° at an increment of 2.5° between speakers.

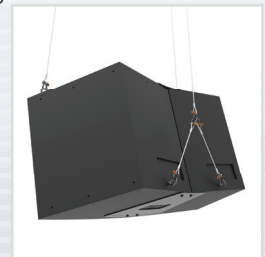

## STANDARD FEATURES:

- ▶ Top and bottom load-rated clustering plates
- ▶ Adjustable splay angles
- ▶ Rigging horizontally or vertically

### SPECIFICATIONS:

**Material:** Structural Steel Alloy

**Finish:** Powder Coat

**Color:** Black

**Design Factor: 5:1 ratio**

**WLL:** 400 lb. / 182 Kg.

**Shipping Weight:** 28 lb. / 12.7 Kg.

### PACKAGE CONTENTS:

**2pcs** Joiner Plates

**4pcs** Eyebolt, M10X35mm

**1pc**      Hardware Kit

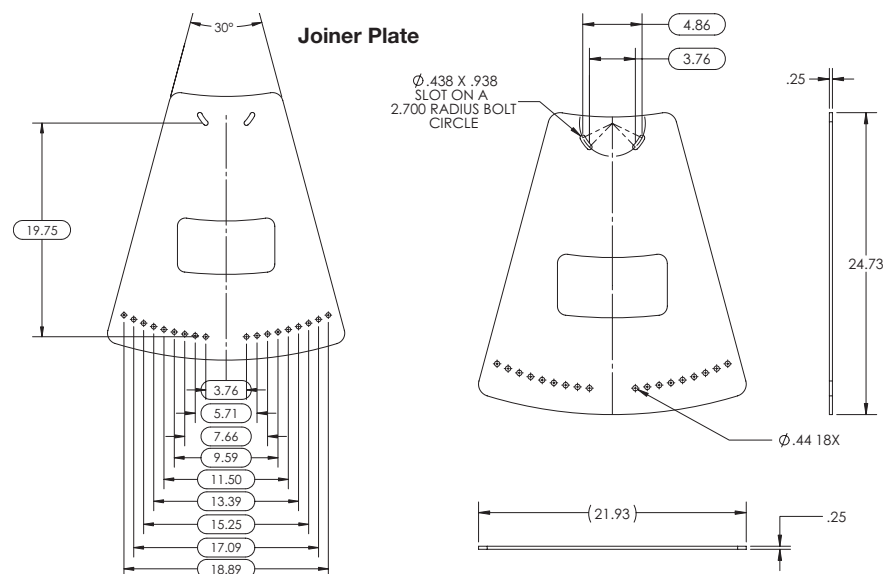

**Adaptive Technologies Group**  
1635 E. Burnett Street | Signal Hill, CA 90755 USA  
Ph: 562.424.1100 | Fax: 562.424.3520  
[www.adapttechgroup.com](http://www.adapttechgroup.com)



**ALWAYS INSTALL SAFETY CABLES**

**WARNING:** Mounting and/or suspension of audio and video equipment requires experienced professionals. Improperly installed loudspeakers can result in property damage, personal injury and/or liability to the installing contractor.