

Interlocking Flyable LCD Video Wall System

MODULAR FLYING VIDEO WALL FRAME SYSTEM

SHARP V601 / V602



Assemble and fly large concert quality and seamless video walls, quickly and securely using the Adaptive's load-rated modular LCD framing system for Sharp V601 / V602 LCD monitors.

Precision-machined connecting bars and compression locks link multiple LCD frames together, horizontally and vertically into a rigid framework that supports multiple LCD's. Precisely dimensioned mounting frames and LCD monitors are assembled in tiers, up to 8 deep and then the assembly is flown utilizing a loadrated rigging beam and suspension component system.



Rated for indoor use.

Adaptive Technologies Group
1635 E. Burnett Street | Signal Hill, CA 90755 USA
Ph: 562.424.1100 | Fax: 562.424.3520
www.adapttechgroup.com



ALWAYS INSTALL SAFETY CABLES

WARNING: Mounting and/or suspension of audio and video equipment requires experienced professionals. Improperly installed loudspeakers can result in property damage, personal injury and/or liability to the installing contractor.

Interlocking Flyable LCD Video Wall System

2 of 13

MODULAR FLYING VIDEO WALL FRAME SYSTEM

SHARP V601 / V602

As each tier is assembled, LCDs are loaded into slotted tracks that lock the LCD's into a nearly seamless position. Completed tiers are secured to the overhead rigging beam or to an upper tier, eliminating the substantial hours required to assemble and align traditional video walls.

Disassembling video walls is just as easy and safe through the use of quick release aircraft pins and custom handles.

Rigging Beams in Landscape Orientation



Connect frames horizontally



Load LCD's into frames



Assemble Rigging Beam to frames



Hoist first tier above assembly area



Assemble next tier



Assemble next or last tier

Features:

- Expands horizontally and vertically.
- Landscape or portrait orientations.
- Load-rated Rigging Beams from 1 column to 5 columns and up to 8 monitors deep.
- Rigging Beam also secures to bottom of video wall for tilting.
- Cam-style compression locks provide seamless alignment between LCDs.
- Precision-machined connecting bars provide rugged overhead lifting and alignment.
- Powder-coated welded alloy steel frames.
- Quick-release locking pins make setup and teardown fast and simple.
- Optional free-standing leg supports makes setup easier and more predictable.



Fly and aim assembled video wall



Rated for indoor use.

ALWAYS INSTALL SAFETY CABLES

WARNING: Mounting and/or suspension of audio and video equipment requires experienced professionals. Improperly installed loudspeakers can result in property damage, personal injury and/or liability to the installing contractor.

Interlocking Flyable LCD Video Wall System

3 of 13

MODULAR FLYING VIDEO WALL FRAME SYSTEM

SHARP V601 / V602

CONFIGURATIONS

The following configurations represent popular video display patterns, but many more variables are available. Contact our applications department for assistance in designing a custom display that assures a safe and easy to install video wall.

1 X 4 Flying Video Wall (Landscape)

1 wide by 4 deep LCD's

FOR PERMANENT INSTALLATIONS

4 pcs.	MVFS-V601-T	LCD Frame
1 pc.	MVFS-V601-X1RBL	1-Wide Rigging Beam
2 pcs.	MVFS-1.5X2-SME	Shackle Mount
1pc.	MVFS-V601-X4RBP	Rigging Beam Portrait (used as a back brace)

OPTIONAL (ADD THE FOLLOWING KITS FOR STAGING AND RENTALS)

4 each	MVFS-025-T-QRP	LCD Frame - Quick Pin Lanyard Kit
1 each	MVFS-1.5-X1QRP	Rigging Beam - Quick Pin Lanyard Kit
2 each	MVFS-375-ME-QRP	Shackle Mount - Quick Pin Lanyard Kit

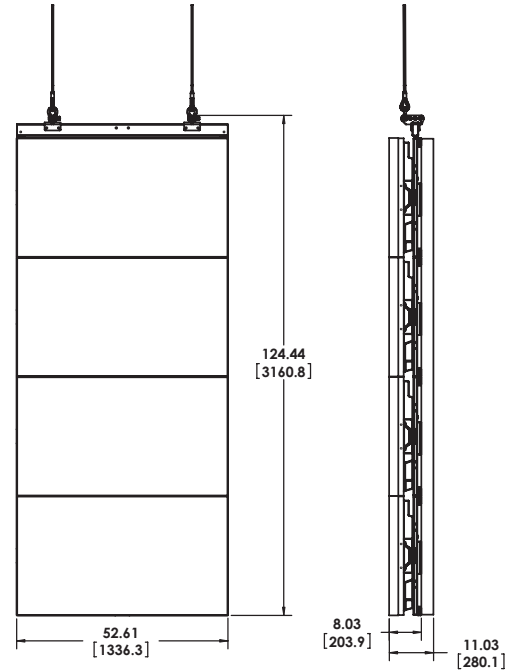

1 X 2 Flying Video Wall (Portrait)

1 wide by 2 deep LCD's

FOR PERMANENT INSTALLATIONS

2 pcs.	MVFS-V601-T	LCD Frame
1 pc.	MVFS-V601-X1RBP	1-Wide Rigging Beam
2 pcs.	MVFS-1.5X2-SME	Shackle Mount
1pc.	MVFS-V601-X2RBL	Rigging Beam Landscape (used as a back brace)

OPTIONAL (ADD THE FOLLOWING KITS FOR STAGING AND RENTALS)

2 each	MVFS-025-T-QRP	LCD Frame - Quick Pin Lanyard Kit
1 each	MVFS-1.5-X1QRP	Rigging Beam - Quick Pin Lanyard Kit
2 each	MVFS-375-ME-QRP	Shackle Mount - Quick Pin Lanyard Kit

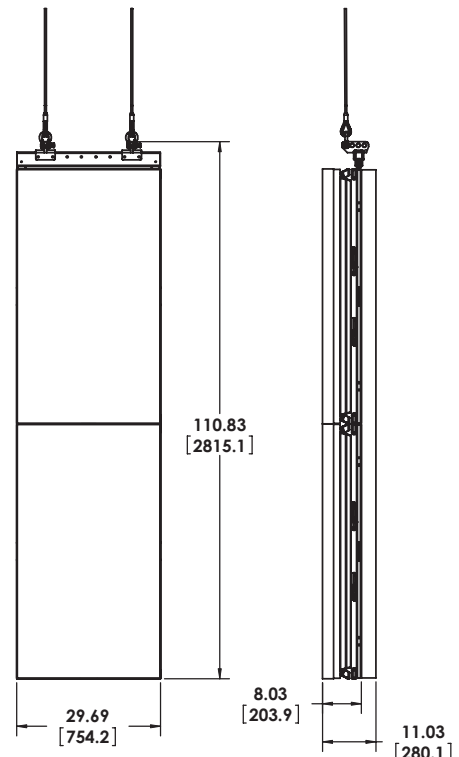

Rated for indoor use.

Adaptive Technologies Group
1635 E. Burnett Street | Signal Hill, CA 90755 USA
Ph: 562.424.1100 | Fax: 562.424.3520
www.adapttechgroup.com



ALWAYS INSTALL SAFETY CABLES

WARNING: Mounting and/or suspension of audio and video equipment requires experienced professionals. Improperly installed loudspeakers can result in property damage, personal injury and/or liability to the installing contractor.

Interlocking Flyable LCD Video Wall System

4 of 13

MODULAR FLYING VIDEO WALL FRAME SYSTEM

SHARP V601 / V602

ONE-COLUMN RIGGING BEAMS

MAXIMUM OF 8 MONITORS PER COLUMN

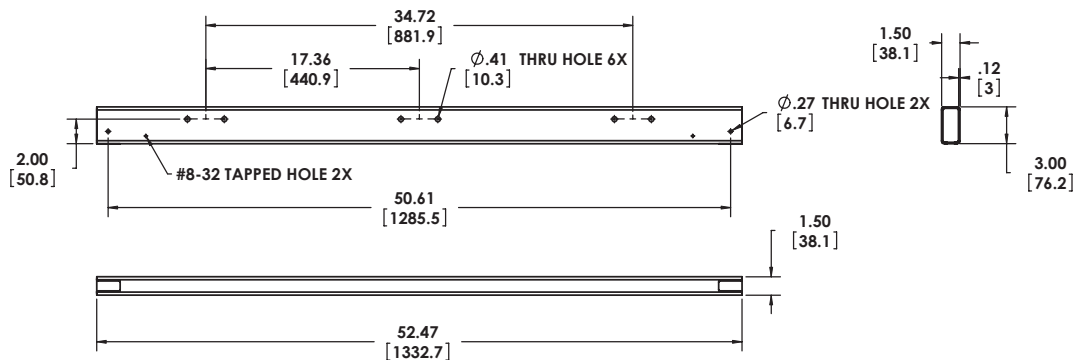

MVFS-V601-X1RBL (Landscape)

One column rigging beam,
up to 8 monitors deep, maximum

Working load:	Using two inner hang points = 1060 lb./482 Kg
Working load:	Using two outer hang points = 895 lb./407 Kg
Design Factor:	10:1 ratio
Material:	Alloy Steel tubing
Finish:	Powder coat paint
Color:	Black
Weight:	13.1 lb./5.6 Kg
Shipping weight:	21.4 lb./9.7 Kg
Pack Count:	One

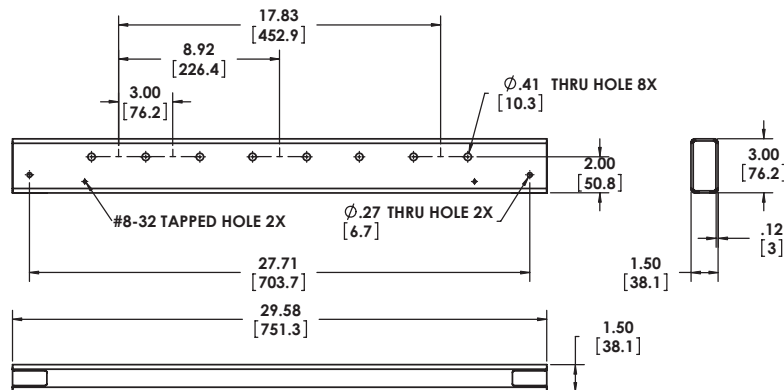

MVFS-V601-X1RBP (Portrait)

One column rigging beam,
up to 8 monitors deep, maximum

Working load:	Using two hang points (inner and outer)= 982 lb./446.4 kg
Design Factor:	10:1 ratio
Material:	Alloy Steel tubing
Finish:	Powder coat paint
Color:	Black
Weight:	7.25 lb./3.3 Kg
Shipping weight:	11 lb.5 kg
Pack Count:	One



Rated for indoor use.

ALWAYS INSTALL SAFETY CABLES

WARNING: Mounting and/or suspension of audio and video equipment requires experienced professionals. Improperly installed loudspeakers can result in property damage, personal injury and/or liability to the installing contractor.

Interlocking Flyable LCD Video Wall System

5 of 13

MODULAR FLYING VIDEO WALL FRAME SYSTEM

SHARP V601 / V602

CONFIGURATIONS

The following configurations represent popular video display patterns, but many more variables are available. Contact our applications department for assistance in designing a custom display that assures a safe and easy to install video wall.

2 X 2 Flying Video Wall (Landscape)

2 wide by 2 deep LCD's

FOR PERMANENT INSTALLATIONS

4 pcs.	MVFS-V601-T	LCD Frame
1 pc.	MVFS-V601-X2RBL	2-Wide Rigging Beam
2 pcs.	MVFS-1.5X2-SME	Shackle Mount
2pc.	MVFS-V601-X2RBP	Rigging Beam Portrait (used as a back brace)

OPTIONAL (ADD THE FOLLOWING KITS FOR STAGING AND RENTALS)

4 each	MVFS-025-T-QRP	LCD Frame - Quick Pin Lanyard Kit
1 each	MVFS-1.5-X2QRP	Rigging Beam - Quick Pin Lanyard Kit
2 each	MVFS-375-ME-QRP	Shackle Mount - Quick Pin Lanyard Kit

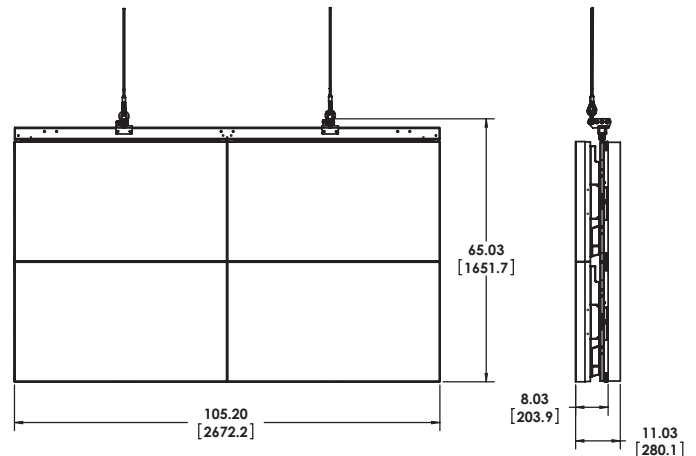

2 X 2 Flying Video Wall (Portrait)

2 wide by 2 deep LCD's

FOR PERMANENT INSTALLATIONS

4 pcs.	MVFS-V601-T	LCD Frame
1 pc.	MVFS-V601-X2RBP	2-Wide Rigging Beam
2 pcs.	MVFS-1.5X2-SME	Shackle Mount
2pcs.	MVFS-V601-X2RBL	Rigging Beam Landscape used as a back brace)

OPTIONAL (ADD THE FOLLOWING KITS FOR STAGING AND RENTALS)

4 each	MVFS-025-T-QRP	LCD Frame - Quick Pin Lanyard Kit
1 each	MVFS-1.5-X2QRP	Rigging Beam - Quick Pin Lanyard Kit
2 each	MVFS-375-ME-QRP	Shackle Mount - Quick Pin Lanyard Kit

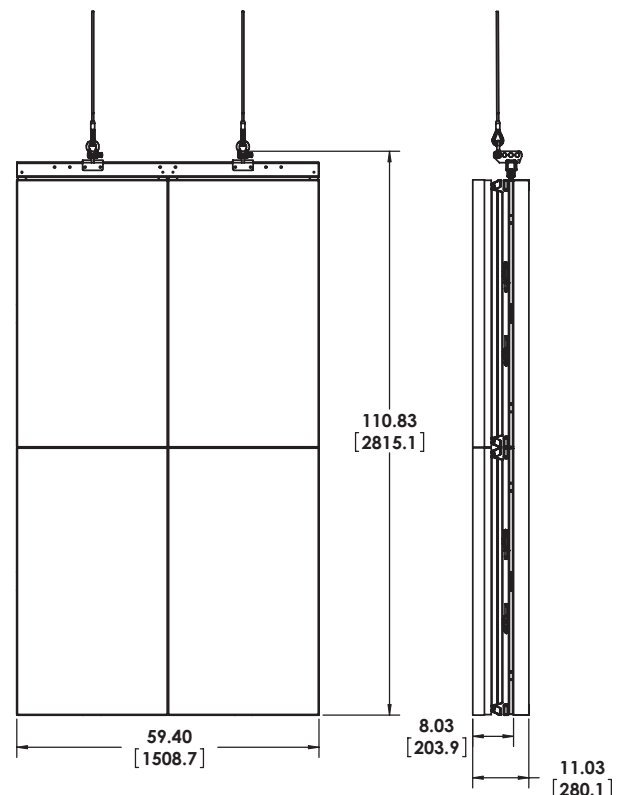

Rated for indoor use.

Adaptive Technologies Group
1635 E. Burnett Street | Signal Hill, CA 90755 USA
Ph: 562.424.1100 | Fax: 562.424.3520
www.adapttechgroup.com



ALWAYS INSTALL SAFETY CABLES

WARNING: Mounting and/or suspension of audio and video equipment requires experienced professionals. Improperly installed loudspeakers can result in property damage, personal injury and/or liability to the installing contractor.

Interlocking Flyable LCD Video Wall System

6 of 13

MODULAR FLYING VIDEO WALL FRAME SYSTEM

SHARP V601 / V602

TWO-COLUMN RIGGING BEAMS

MAXIMUM OF 8 MONITORS PER COLUMN

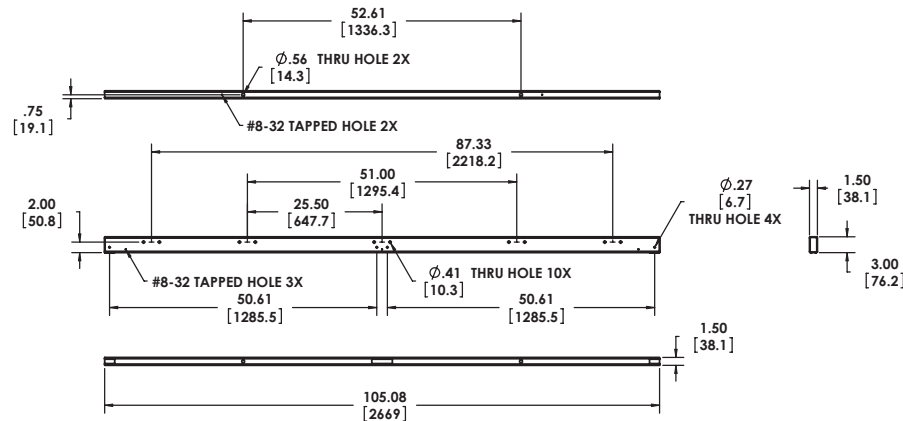

MVFS-V601-X2RBL (Landscape)

Two column rigging beam,
up to 8 monitors deep, maximum

Working load:	Using two inner hang points = 1060 lb./482 Kg
Working load:	Using two outer hang points = 895 lb./407 Kg
Design Factor:	10:1 ratio
Material:	Alloy Steel tubing
Finish:	Powder coat paint
Color:	Black
Weight:	13.1 lb./5.6 Kg
Shipping weight:	21.4 lb./9.7 Kg
Pack Count:	One

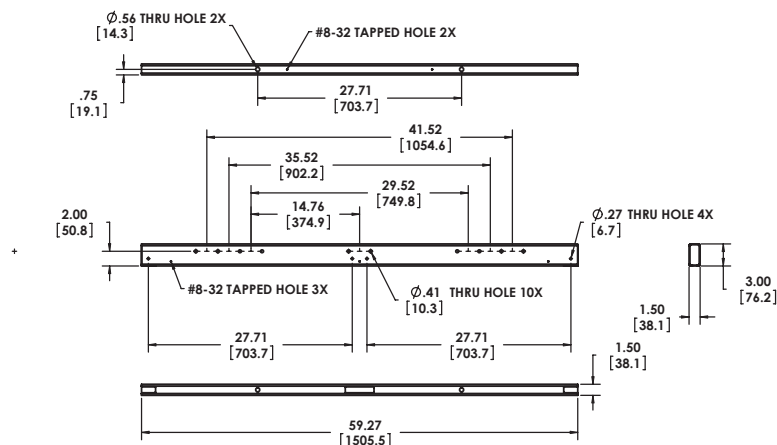

MVFS-V601-X2RBP (Portrait)

Two column rigging beam,
up to 8 monitors deep, maximum

Working load:	Using two hang points (inner and outer)= 982 lb./446.4 Kg
Design Factor:	10:1 ratio
Material:	Alloy Steel tubing
Finish:	Powder coat paint
Color:	Black
Weight:	7.25 lb./3.3 Kg
Shipping weight:	11 lb./5 kg
Pack Count:	One



Rated for indoor use.

Adaptive Technologies Group
1635 E. Burnett Street | Signal Hill, CA 90755 USA
Ph: 562.424.1100 | Fax: 562.424.3520
www.adapttechgroup.com



ALWAYS INSTALL SAFETY CABLES

WARNING: Mounting and/or suspension of audio and video equipment requires experienced professionals. Improperly installed loudspeakers can result in property damage, personal injury and/or liability to the installing contractor.

Interlocking Flyable LCD Video Wall System

7 of 13

MODULAR FLYING VIDEO WALL FRAME SYSTEM

SHARP V601 / V602

CONFIGURATIONS

The following configurations represent popular video display patterns, but many more variables are available. Contact our applications department for assistance in designing a custom display that assures a safe and easy to install video wall.

3 X 3 Flying Video Wall(Landscape)

3 wide by 3 deep LCD's

FOR PERMANENT INSTALLATIONS

9 pcs.	MVFS-V601-T	LCD Frame
1 pc.	MVFS-V601-X3RBL	3-Wide Rigging Beam
2 pcs.	MVFS-1.5X2-SME	Shackle Mount
2 pcs.	MVFS-V601-X3RBP	3-Wide Rigging Beam (used as a back brace)

OPTIONAL (ADD THE FOLLOWING KITS FOR STAGING AND RENTALS)

9 each	MVFS-025-T-QRP	LCD Frame - Quick Pin Lanyard Kit
1 each	MVFS-1.5-X3QRP	Rigging Beam - Quick Pin Lanyard Kit
2 each	MVFS-375-ME-QRP	Shackle Mount - Quick Pin Lanyard Kit

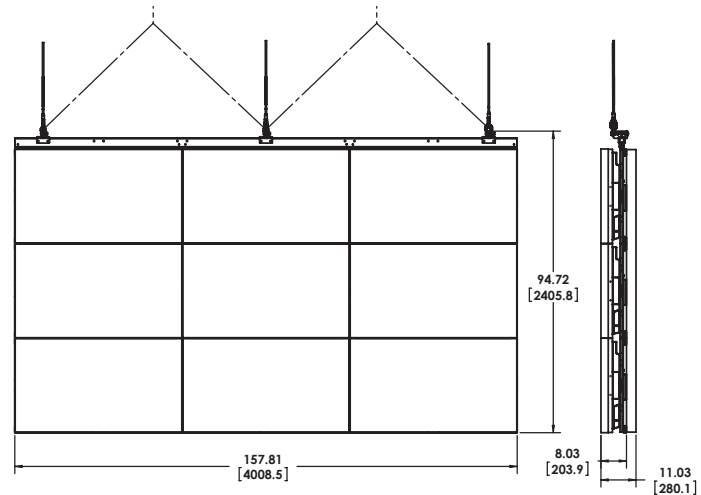

3 X 3 Flying Video Wall (Portrait)

3 wide by 3 deep LCD's

FOR PERMANENT INSTALLATIONS

9 pcs.	MVFS-V601-T	LCD Frame
1 pc.	MVFS-V601-X3RBP	3-Wide Rigging Beam
2 pcs.	MVFS-1.5X2-SME	Shackle Mount
2 pcs.	MVFS-V601-X3RBL	3-Wide Rigging Beam (used as a back brace)

OPTIONAL (ADD THE FOLLOWING KITS FOR STAGING AND RENTALS)

9 each	MVFS-025-T-QRP	LCD Frame - Quick Pin Lanyard Kit
1 each	MVFS-1.5-X3QRP	Rigging Beam - Quick Pin Lanyard Kit
2 each	MVFS-375-ME-QRP	Shackle Mount - Quick Pin Lanyard Kit

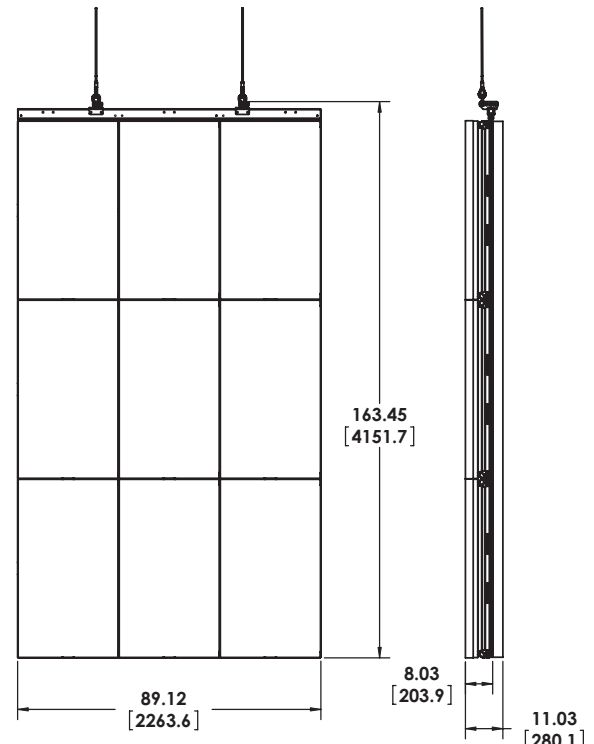

Rated for indoor use.

Adaptive Technologies Group
1635 E. Burnett Street | Signal Hill, CA 90755 USA
Ph: 562.424.1100 | Fax: 562.424.3520
www.adapttechgroup.com



ALWAYS INSTALL SAFETY CABLES

WARNING: Mounting and/or suspension of audio and video equipment requires experienced professionals. Improperly installed loudspeakers can result in property damage, personal injury and/or liability to the installing contractor.

Interlocking Flyable LCD Video Wall System

8 of 13

MODULAR FLYING VIDEO WALL FRAME SYSTEM

SHARP V601 / V602

THREE-COLUMN RIGGING BEAMS

MAXIMUM OF 8 MONITORS PER COLUMN

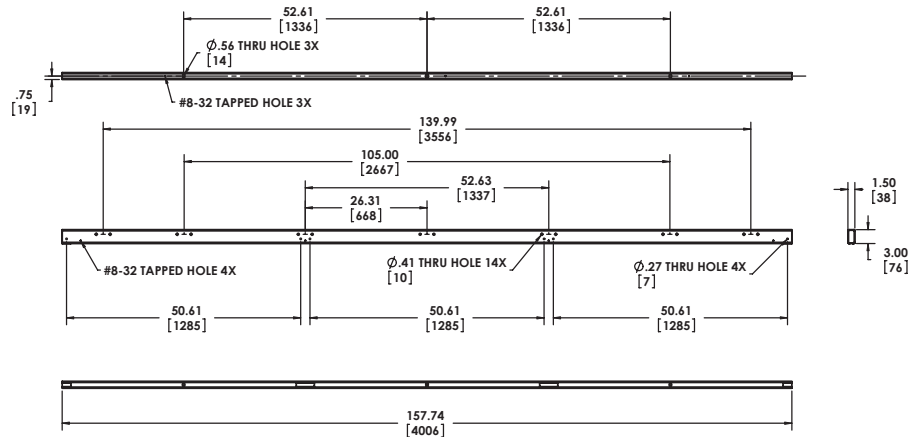

MVFS-V601-X3RBL (Landscape)

Three column rigging beam,
up to 8 monitors deep, maximum

Working load:	Using two hang points (Inner holes)= 1002 lb./455.5 Kg.
Working load:	Using Three hang points = 1768 lb./804 Kg.
Design Factor:	10:1 ratio
Material:	Alloy Steel tubing
Finish:	Powder coat paint
Color:	Black
Weight:	39.3 lb./17.9 Kg.
Shipping weight:	47.6 lb./21.6 Kg.
Pack Count:	One

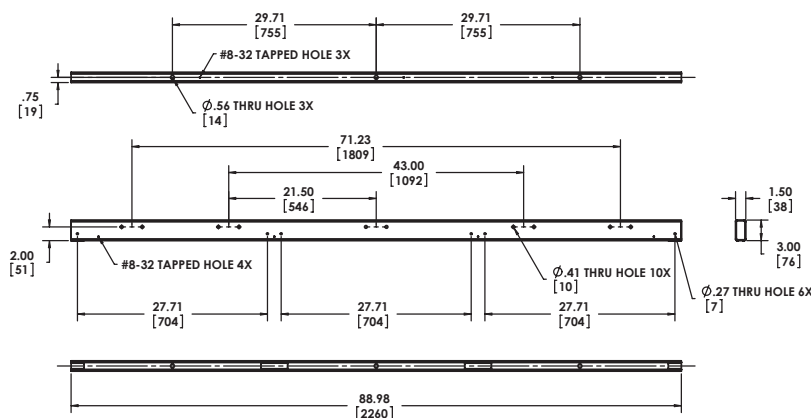

MVFS-V601-X3RBP (Portrait)

Three column rigging beam,
up to 8 monitors deep, maximum

Working load:	Using two hang points (inner & outer holes) = 1746 lb./794 Kg.
Working load:	Using three hang points = 2964 lb./1347 Kg.
Design Factor:	10:1 ratio
Material:	Alloy Steel tubing
Finish:	Powder coat paint
Color:	Black
Weight:	21.92 lb./10 Kg.
Shipping weight:	30.2 lb./13.7 Kg.
Pack Count:	One



Rated for indoor use.

ALWAYS INSTALL SAFETY CABLES

WARNING: Mounting and/or suspension of audio and video equipment requires experienced professionals. Improperly installed loudspeakers can result in property damage, personal injury and/or liability to the installing contractor.

Interlocking Flyable LCD Video Wall System

9 of 13

MODULAR FLYING VIDEO WALL FRAME SYSTEM

SHARP V601 / V602

CONFIGURATIONS

The following configurations represent popular video display patterns, but many more variables are available. Contact our applications department for assistance in designing a custom display that assures a safe and easy to install video wall.

4 X 4 Flying Video Wall (Landscape)

4 wide by 4 deep LCD's

FOR PERMANENT INSTALLATIONS

16 pcs.	MVFS-V601-T	LCD Frame
1 pc.	MVFS-V601-X4RBL	4-Wide Rigging Beam
4 pcs.	MVFS-1.5X2-SME	Shackle Mount
2 pcs.	MVFS-V601-X4RBP	4-Wide Rigging Beam (used as a back brace)

OPTIONAL (ADD THE FOLLOWING KITS FOR STAGING AND RENTALS)

16 each	MVFS-025-T-QRP	LCD Frame - Quick Pin Lanyard Kit
1 each	MVFS-1.5-X4QRP	Rigging Beam - Quick Pin Lanyard Kit
4 each	MVFS-375-ME-QRP	Shackle Mount - Quick Pin Lanyard Kit

Note: 2 pcs. 2-Way Rigging Beams with one MVFS-1.5X2-SMC Beam Connector may also be used in place of the 4-Way Rigging Beam.

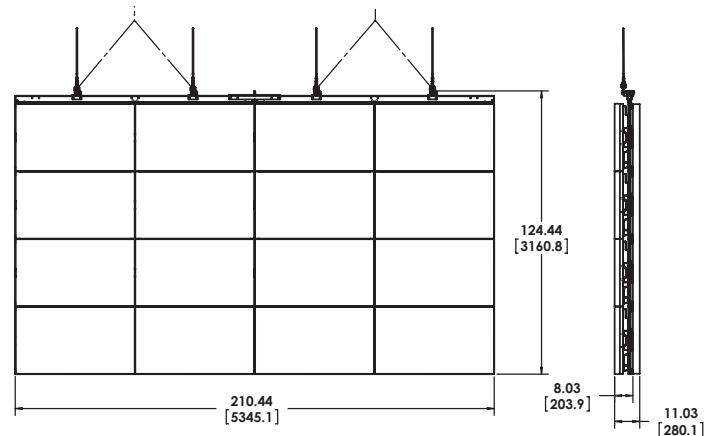

4 X 3 Flying Video Wall (Portrait)

4 wide by 3 deep LCD's

FOR PERMANENT INSTALLATIONS

12 pcs.	MVFS-V601-T	LCD Frame
1 pc.	MVFS-V601-X4RBP	4-Wide Rigging Beam
3 pcs.	MVFS-1.5X2-SME	Shackle Mount
2 pcs.	MVFS-V601-X3RBL	3-Wide Rigging Beam (used as a back brace)

OPTIONAL (ADD THE FOLLOWING KITS FOR STAGING AND RENTALS)

12 each	MVFS-025-T-QRP	LCD Frame - Quick Pin Lanyard Kit
1 each	MVFS-1.5-X4QRP	Rigging Beam - Quick Pin Lanyard Kit
1 each	MVFS-375-ME-QRP	Shackle Mount - Quick Pin Lanyard Kit

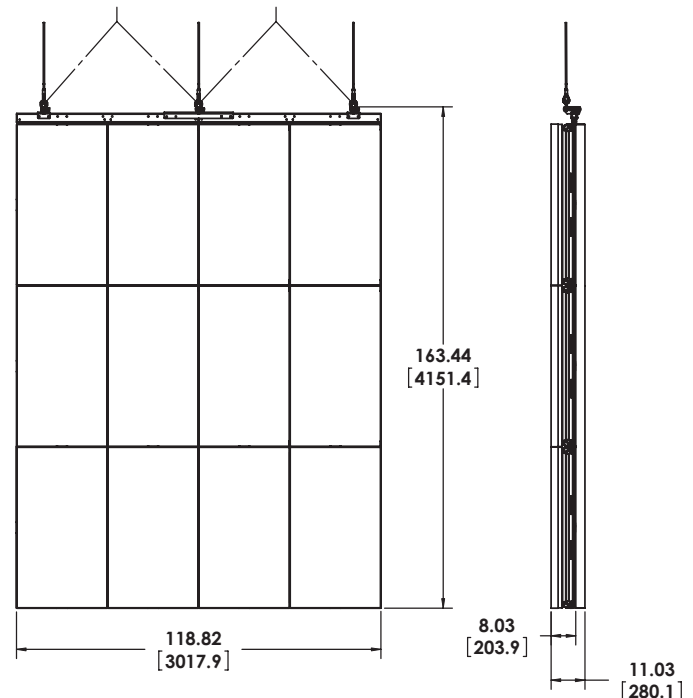

Rated for indoor use.

Adaptive Technologies Group
1635 E. Burnett Street | Signal Hill, CA 90755 USA
Ph: 562.424.1100 | Fax: 562.424.3520
www.adapttechgroup.com



ALWAYS INSTALL SAFETY CABLES

WARNING: Mounting and/or suspension of audio and video equipment requires experienced professionals. Improperly installed loudspeakers can result in property damage, personal injury and/or liability to the installing contractor.

Interlocking Flyable LCD Video Wall System

10 of 13

MODULAR FLYING VIDEO WALL FRAME SYSTEM

SHARP V601 / V602

FOUR-COLUMN RIGGING BEAMS

MAXIMUM OF 8 MONITORS PER COLUMN

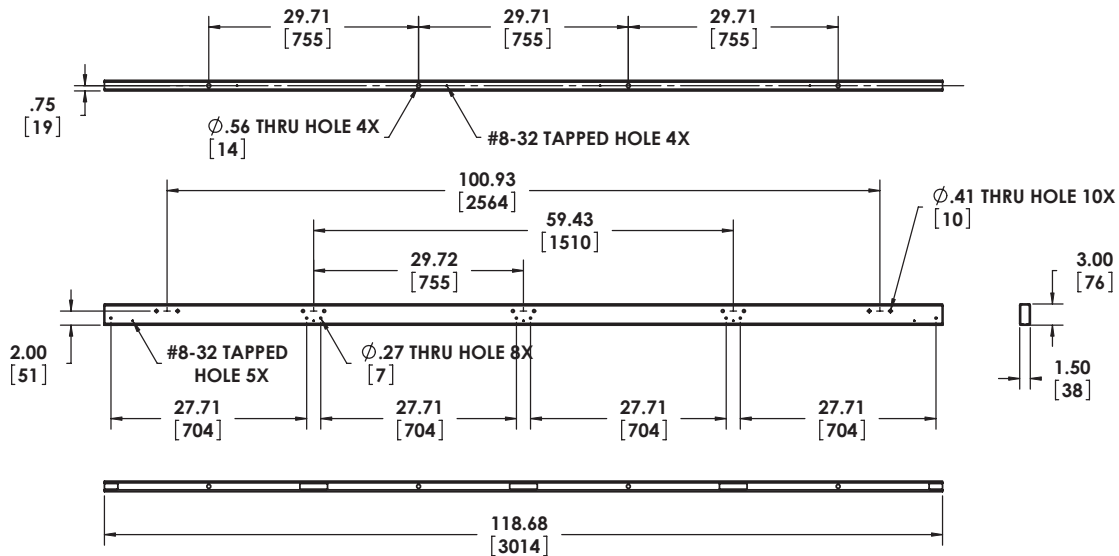

MVFS-V601-X4RBP (Portrait)

Four column rigging beam,
up to 8 monitors deep, maximum

Working load:	Using two hang points (inner holes) = 1181 lb./537 Kg. Using Three hang points (Outer holes) = 1759 lb/799 Kg. Using four Hang points = 2942 lb./1337 Kg.
Design Factor:	10:1 ratio
Material:	Alloy Steel tubing
Finish:	Powder coat paint
Color:	Black
Weight:	29.3 lb./13.3 Kg.
Shipping weight:	37.25 lb./16.9 Kg.
Pack Count:	One



Rated for indoor use.

ALWAYS INSTALL SAFETY CABLES

WARNING: Mounting and/or suspension of audio and video equipment requires experienced professionals. Improperly installed loudspeakers can result in property damage, personal injury and/or liability to the installing contractor.

Interlocking Flyable LCD Video Wall System

11 of 13

MODULAR FLYING VIDEO WALL FRAME SYSTEM

SHARP V601 / V602

5 X 5 Flying Video Wall (Landscape)

5 wide by 5 deep LCD's

FOR PERMANENT INSTALLATIONS

25 pcs.	MVFS-V601-T	LCD Frame
1 pc.	MVFS-V601-X2RBL	2-Wide Rigging Beam
1 pc.	MVFS-V601-X3RBL	3-Wide Rigging Beam
1 pc.	MVFS-1.5X2-SMC	Beam Connector
4 pcs.	MVFS-1.5X2-SME	Shackle Mount
3 pcs.	MVFS-V601-X5RBP	5-Wide Rigging Beam (used as a back brace)

OPTIONAL (ADD THE FOLLOWING KITS FOR STAGING AND RENTALS)

25 each	MVFS-025-T-QRP	LCD Frame - Quick Pin Lanyard Kit
1 each	MVFS-1.5-X2QRP	Rigging Beam - Quick Pin Lanyard Kit
1 each	MVFS-1.5-X3QRP	Rigging Beam - Quick Pin Lanyard Kit
4 each	MVFS-375-ME-QRP	Shackle Mount - Quick Pin Lanyard Kit
1 each	MVFS-375-MC-QRP	Beam Connector - Quick Pin Lanyard Kit

CONFIGURATIONS

The following configurations represent popular video display patterns, but many more variables are available. Contact our applications department for assistance in designing a custom display that assures a safe and easy to install video wall.

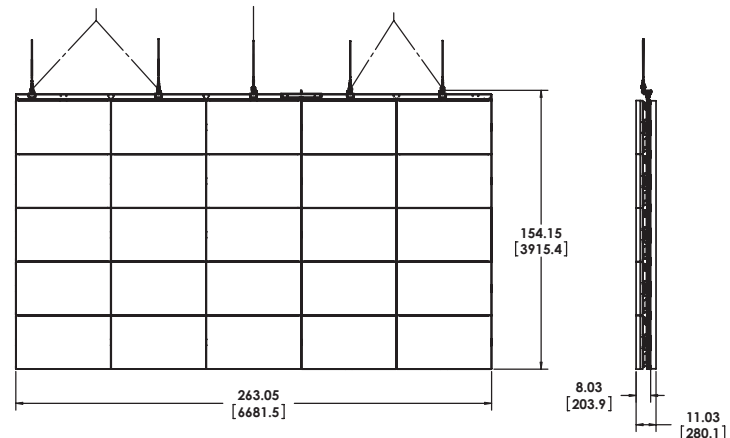

5 X 3 Flying Video Wall (Portrait)

5 wide by 3 deep LCD's

FOR PERMANENT INSTALLATIONS

15 pcs.	MVFS-V601-T	LCD Frame
1 pc.	MVFS-V601-X2RBP	2-Wide Rigging Beam
1 pc.	MVFS-V601-X3RBP	3-Wide Rigging Beam
4 pcs.	MVFS-1.5X2-SME	Shackle Mount
1 pc.	MVFS-1.5X2-SMC	Beam Connector
3 pcs.	MVFS-V601-X3RBL	3-Wide Rigging Beam (used as a back brace)

OPTIONAL (ADD THE FOLLOWING KITS FOR STAGING AND RENTALS)

15 each	MVFS-025-T-QRP	LCD Frame - Quick Pin Lanyard Kit
1 each	MVFS-1.5-X2QRP	Rigging Beam - Quick Pin Lanyard Kit
1 each	MVFS-1.5-X3QRP	Rigging Beam - Quick Pin Lanyard Kit
3 each	MVFS-375-ME-QRP	Shackle Mount - Quick Pin Lanyard Kit
1 each	MVFS-375-MC-QRP	Beam Connector - Quick Pin Lanyard Kit

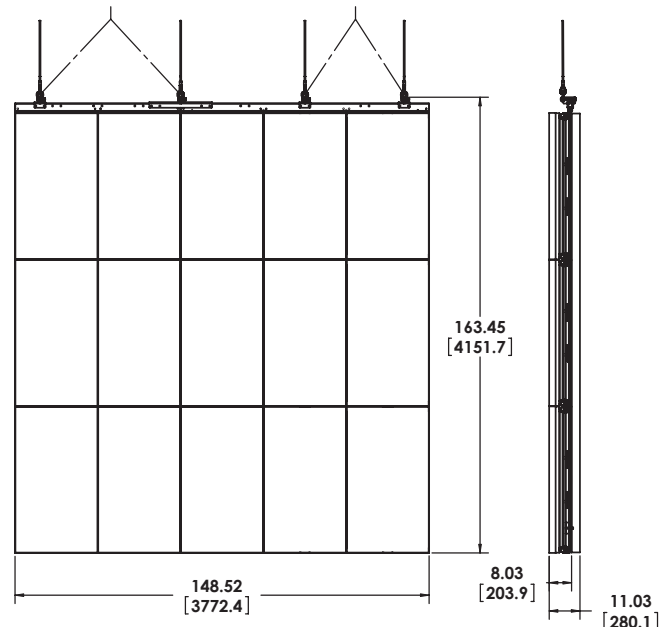

Rated for indoor use.

ALWAYS INSTALL SAFETY CABLES

WARNING: Mounting and/or suspension of audio and video equipment requires experienced professionals. Improperly installed loudspeakers can result in property damage, personal injury and/or liability to the installing contractor.

Interlocking Flyable LCD Video Wall System

12 of 13

MODULAR FLYING VIDEO WALL FRAME SYSTEM

SHARP V601 / V602

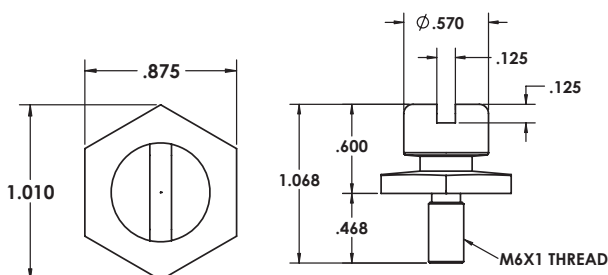
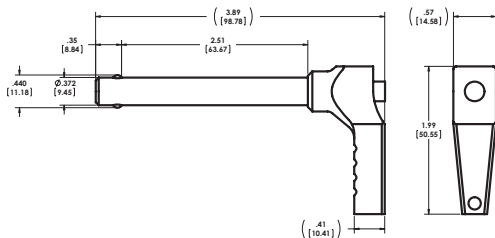
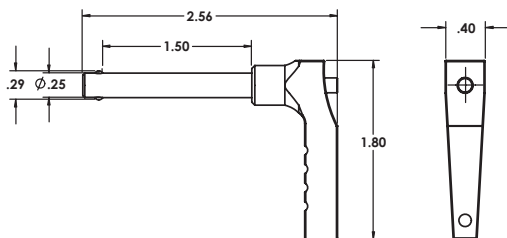
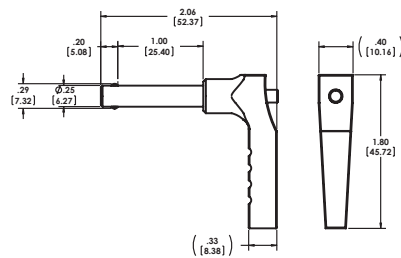
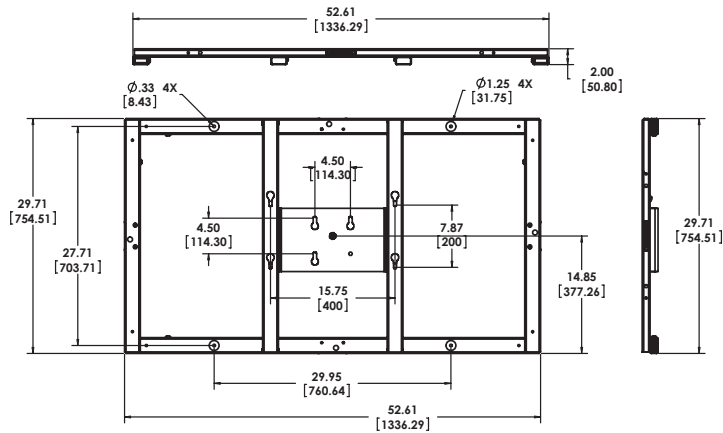

DIMENSIONS:

MVFS-V601-T LCD Frame

Working Load:	264 lb. / 120 Kg.
Design Factor:	10:1 ratio
Weight:	40 lb. / 18.2 Kg.
Shipping weight:	45 lb. / 20.5 Kg.
Pack Count:	One
Material:	Steel alloy tubing and high strength aluminum connecting bars
Finish:	Powder coat paint
Color:	Black
Contents:	1 Frame

MVFS-025-T-QRP LCD Frame Quick Pin/Lanyard Kit

Working Load:	8,200 lb. / 3,727 Kg. (double shear)
Design Factor:	5:1 ratio
Material:	High-strength steel
Finish:	Satin
Color:	Silver
Contents:	8 QRP's / Lanyard assemblies and hardware

Rigging Beam Quick Pin/ Lanyard Kits

MVFS-1.5-X1QRP	2pcs.	Quick Pin/Lanyard Kit
MVFS-1.5-X2QRP	4 pcs.	Quick Pin/Lanyard Kit
MVFS-1.5-X3QRP	6 pcs.	Quick Pin/Lanyard Kit
MVFS-1.5-X4QRP	8 pcs.	Quick Pin/Lanyard Kit

Working Load:	8,200 lb. / 3,727 Kg. (double shear)
Design Factor:	5:1 ratio
Material:	High-strength steel
Finish:	Satin
Color:	Silver

Shackle Mount & Beam Connector Quick Pin/Lanyard Kits

MVFS-375-ME-QRP	2pcs.	Shackle Mount - Quick Pin/Lanyard Kit
MVFS-375-MC-QRP	4pcs.	Beam Connector - Quick Pin/Lanyard Kit

Working Load:	18,400 lb. / 8,364 Kg. (double shear)
Design Factor:	5:1 ratio
Material:	High-strength steel
Finish:	Satin
Color:	Silver

LCD Stand Off P/N 9-0498 * Adjustable M6 VESA Anchor

Material:	Steel
Finish:	Zinc Plated
Color:	Black
QTY:	4 per monitor

* COMES WITH MVFS-V601-T-FRAME



Rated for indoor use.

ALWAYS INSTALL SAFETY CABLES

WARNING: Mounting and/or suspension of audio and video equipment requires experienced professionals. Improperly installed loudspeakers can result in property damage, personal injury and/or liability to the installing contractor.

Interlocking Flyable LCD Video Wall System

13 of 13

MODULAR FLYING VIDEO WALL FRAME SYSTEM

SHARP V601 / V602

DIMENSIONS:

MVFS-1.5X2-SME Shackle Mount - Extended

Working Load:	990 lb. / 450 Kg
Design Factor:	10:1 ratio
Material:	High-strength steel alloy
Finish:	Powder coat paint
Color:	Black
Weight:	2.7 lb. / 1.2 Kg.
Shipping weight:	3.3 lb. / 1.5 Kg.
Pack Count:	One

MVFS-1.5X2-SMC Rigging Beam Connector – Shackle Mount

Working Load:	624 lb. / 284 Kg
Design Factor:	10:1 ratio
Material:	High-strength steel alloy
Finish:	Powder coat paint
Color:	Black
Weight:	9.0 lb. / 4.1 Kg.
Shipping weight:	11.3 lb. / 5.1 Kg.
Pack Count:	One

MVFS-X461-FOOT * Floor Alignment Stand

Two required per column

Working Load:	Steel alloy tubing
Finish:	Powder coat paint
Color:	Black
Weight:	9.0 lb. / 4.1 Kg.
Shipping weight:	12 lb. / 5.1 Kg.

*** THIS IS AN ASSEMBLY FIXTURE ONLY.
IT IS NOT FOR DISPLAY PURPOSES.**

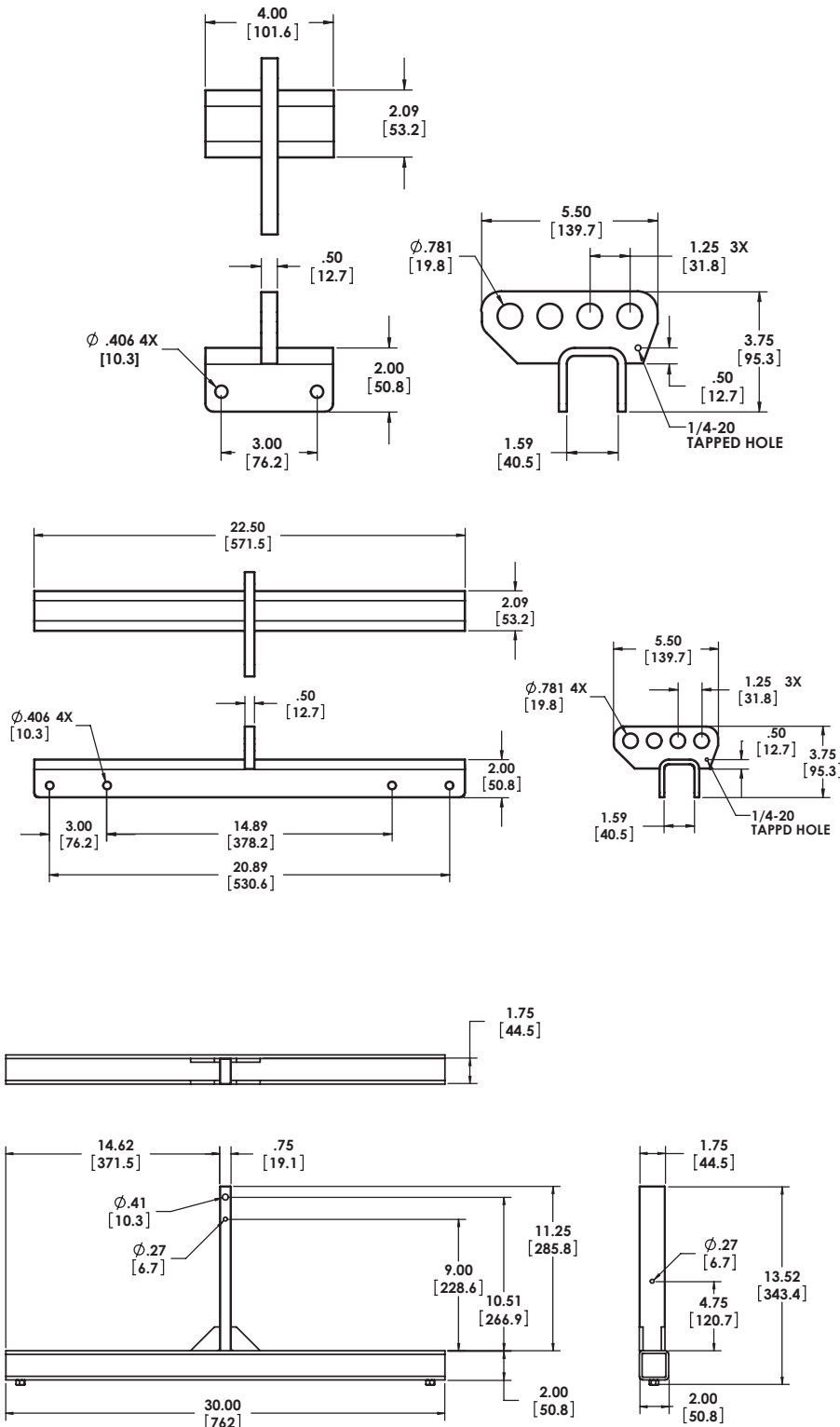

Rated for indoor use.

ALWAYS INSTALL SAFETY CABLES

WARNING: Mounting and/or suspension of audio and video equipment requires experienced professionals. Improperly installed loudspeakers can result in property damage, personal injury and/or liability to the installing contractor.